

CONFERENCE

TABLES with Architectural Bases

Price Guide ◀



TABLE OF CONTENTS

3	General Information
5	Product Specifications
7	Pricing - Conference Tables

General Information

Sales of In2design products are in accordance with the terms and conditions outlined in this Price List. These terms and conditions may be changed or supplemented only by a separately written document signed and authorized by in2design.

Prices

The prices published in this Price List, as well as those quoted by in2design shall be suggested List Prices. List Prices are subject to change without prior notice.

List Prices are those that are in effect at time of order receipt. If shipping date requested is more than 90 days from date of order, in2design shall have the right to use the published list prices effective at the time of shipment.

Taxes

All prices shown in this Price List are exclusive of sales, excise, GST and other applicable taxes. The Purchaser is responsible to remit directly to in2design all such taxes as per the invoice.

A Tax Exemption Certificate (if applicable) must be on file with in2design prior to the product shipment, otherwise, sales tax will be due and payable.

Payment Terms

All orders are invoiced at time of shipment. Terms of payment are NET thirty (30) days from date of invoice.

In2design shall exercise the right to enforce a charge amounting to 2% per month, or 24% annually on any past due invoice or outstanding balance.

All products sold shall remain the personal property of in2design until fully paid. The purchaser agrees to perform all acts which may be necessary to assure retention of title to such products to in2design until such time as the products have been paid in full.

Credit

Should the Purchaser fail to fulfill the terms of payment, in2design may defer further shipments until all such payments are made or may, at its option cancel the unshipped balance without prejudice to any other rights which in2design may have against the Purchaser.

Shipments and deliveries shall at all times be subject to approval of the Purchaser's credit.

Order Placement

In2design requires that all orders be submitted in writing as represented by a valid Purchase Order and accompanied by a layout/drawing to avoid errors and or duplication. The Purchaser is responsible for providing complete and accurate information when placing an order. Orders with incorrect/incomplete information will result in order processing and shipment delays. Product leadtimes will be based upon receipt of a complete and accurate Purchase Order.

Order Acknowledgement

All orders submitted will be acknowledged. It is the Purchaser's responsibility to review the acknowledgement for accuracy. In the event of an error, the Purchaser must notify in2design immediately (within 48 hours) in writing by fax or e-mail.

Delivery Dates

In2design shall exercise its best efforts to deliver within the date specified on the Acknowledgement. In2design shall not incur any obligation or liability to the Purchaser for delay or failure to deliver goods due to causes beyond our control.

Order Changes & Cancellations

Any changes to the original Purchase Order must be received in writing within 48 hrs of the order acknowledgement. Any change to the original Purchase Order beyond the 48 hrs will result in re-scheduling and subject to a restocking charge commensurate with the incurred production costs.

All orders are considered firm and not subject to cancellation by the Purchaser without the written consent of in2design. Special order items and COM items are not subject to changes or cancellation under any circumstances.

COM Orders

A request for non-standard material (laminates) must be approved prior to acceptance of an order. Material must be shipped prepaid to in2design Customer Service Team and properly identified. Performance of COM is the sole responsibility of the Purchaser.

Errors & Omissions

All quotations, acknowledgements and invoices are subject to corrections for any errors and omissions.

Shipping & Delivery

All products are sold F.O.B. in2design's Manufacturing Facility: Vaughan Ontario, unless otherwise stated and agreed.

The Purchaser will determine the method of transportation and the routing of shipment.

Shipping & Delivery

All deliveries will be dock-to-dock, unless otherwise specified.

Shipment Claims

In2design carefully prepares and inspects all products for safe shipment. Legal title to merchandise passes to the Purchaser upon acceptance by the carrier. Inspect all cartons upon delivery.

It is the responsibility of the Purchaser to examine goods upon receipt and to file any claims with the carrier for losses or damage to the product. Details of visible damage should be noted on the delivery receipt. Product shortages must be noted on delivery receipts at the time of delivery and immediately reported to the carrier for correction.

Failure to make any claims against in2design within 10 days shall constitute acceptance of the products and a waiver of any defects, errors or shortages discovered upon inspection.

Product Returns

No return of product will be accepted without the written consent of in2design. Any shipment returned without prior written approval will be refused and returned to the sender freight collect. If approved, a minimum restocking charge of 35% of the original net price shall be charged on returns for credit or refund provided the goods are received in original factory condition.

Storage

In the event the Purchaser requests postponement of the shipment beyond the scheduled delivery date, in2design, in2design may transfer product to storage at the Purchaser's risk and expense. Upon such transfer, the Purchaser assumes risk of loss or damage.

Product Warranty

In2design warrants its products to be free from defects in material and workmanship for a period of ten (10) years from the date of delivery. This warranty extends only to original Purchasers acquiring the product directly from Authorized Dealers and shall apply to product(s) installed by Authorized installers.

This warranty does not extend to C.O.M. applied to in2design products, or products which have been modified or installed contrary to recommended application and installation guidelines.

In2design will not authorize any warranty, parts or labour without the appropriate warranty numbers. All claims with respect to products alleged to be defective must be made within ten (10) days and submitted in writing.

This warranty excludes normal wear and tear, damages caused during shipment or storage; damage due to accident; improper use, negligence or willful abuse; unauthorized alterations or improper installation.

In2design extends no other warranties, expressed or implied, including warranty of merchantability or fitness for a particular purpose. In2design shall not be liable for loss of time, inconvenience, commercial loss, incidental or consequential damages.

Customer Satisfaction

Our goal is to provide the very best service to our customers and to ensure complete product and performance satisfaction. We will exercise our best efforts to achieve this goal.

Quality Standards

All in2design products are ANSI/BIFMA tested and manufactured to ISO 9001 Quality Standards.

Product Specifications

Conference Tables

Tables are available in a vast selection of High Pressure Laminates (HPL) & Melamine Laminates (ML).

Two "styles" are offered with 1.5" Reverse Taper Hardwood Edge & a 3mm thick matching PVC Edge providing durability & user safety. The Hardwood Edge is available on a limited laminate selection & stained to match.

Our Table offering is available in various lengths & widths. Tables are comprised of a Top, Architectural Bases with Silver Corner Accents & Access Panel, Linking Rails, Integrated Wire Management System & Power Centres on Powered units.

Power Centres

Contemporary style power solutions constructed of durable metal in Silver or Black powder coated finishes. Power Centres are available in a multitude of power, USB, data, HDMI, HD VGA & Audio configurations to support technology requirements. Undermount & Desk Top Power Centres are standard in this Table offering. All Power units are UL Listed. Power units are standard with cords with moulded plug or optional hardwire. Cords are available in lengths of 72" & 108".

Wire Management

Conference Tables feature integrated wire management channels to facilitate cables from Undermount Power Centres to Power Strip & Core Drill. For additional details please refer to specification drawings. Desk Top Power registers over Base.

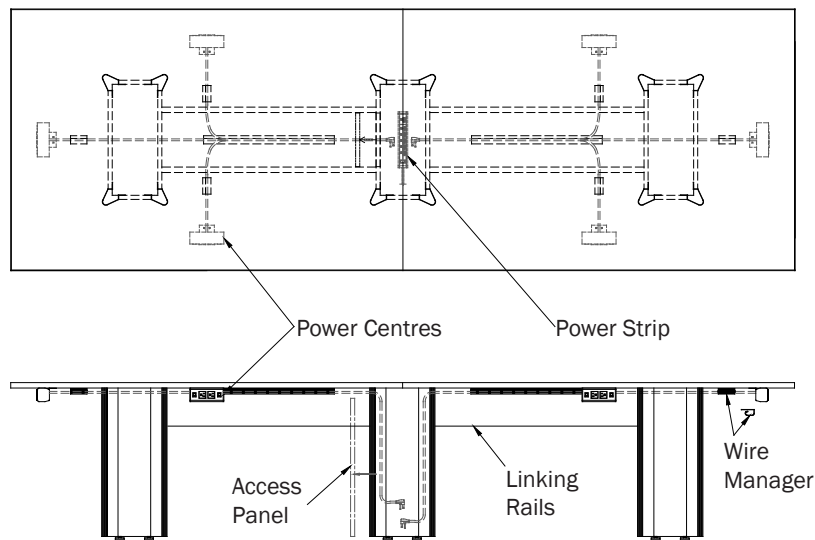

Connections

Metal-to-Metal mini-fix and Dowel Joinery connections. All hardware is included. Each Module is shipped ready to be assembled.

Adjustable Glides

Each Architectural Base is equipped with four (4) 1-5/8" diameter Heavy Duty adjustable glides.

Woodgrain Direction

Standard Woodgrain Direction for Architectural Bases is "vertical", direction for Tops & Support Rails is horizontal (long grain).

Finish Options

Please refer to our website at www.in2-design.com. Please note that finishes for the 1.5" Reverse Taper Hardwood Edge is limited to; Fusion Maple, River Cherry, HiTeak, Milano Oak, Shaker Cherry, Wenge & Cocobala. For custom finishes, please contact your local In2 Design Representative.

Product Codes

Product codes contained herein identify the product category, product size and product attributes. Laminate finish selections are required to complete the product code.

Conference Tables - Product Overview

Square & Rectangular Shape with Desk Top Power

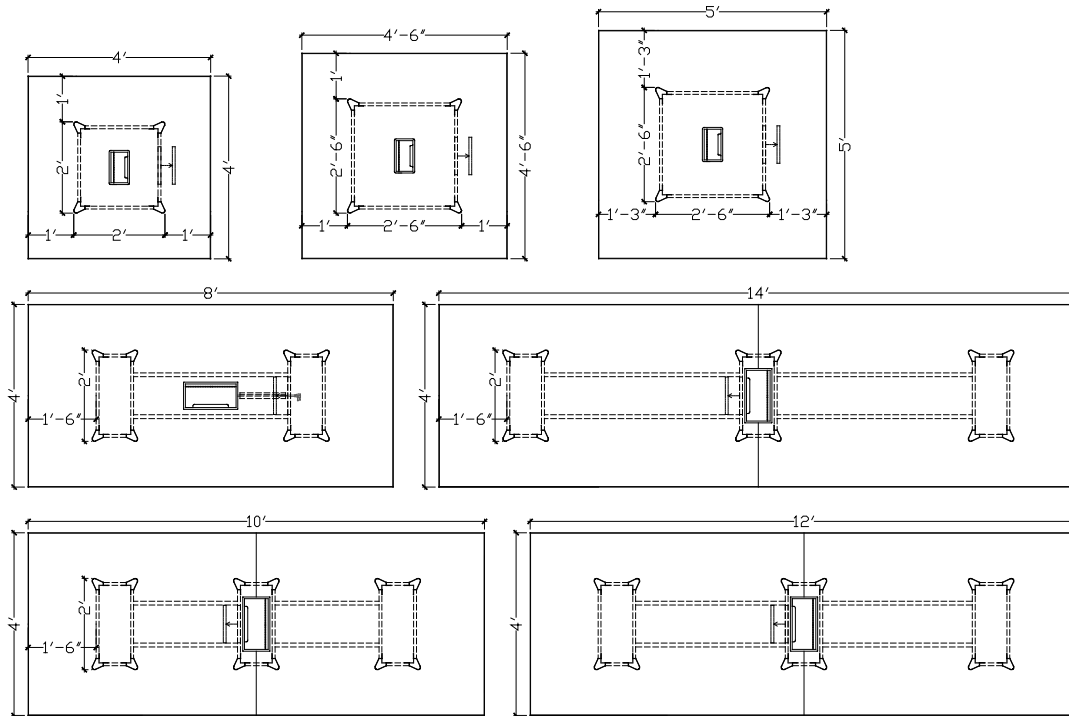

Arched Square & Boat Shape with Desk Top Power

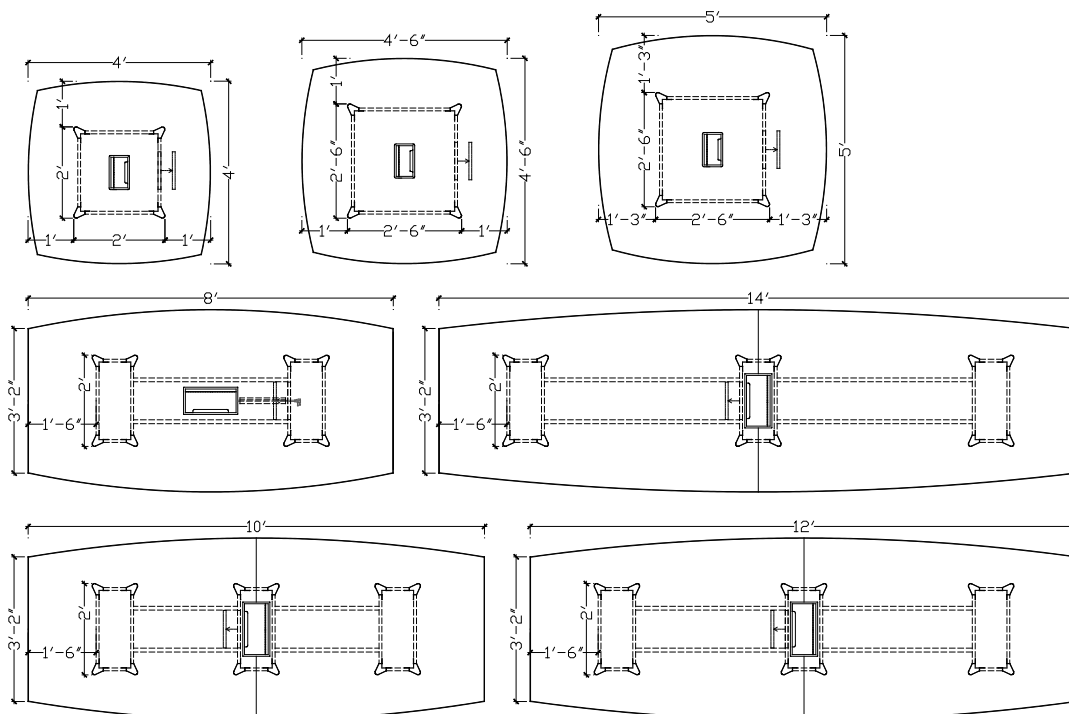

Conference Tables - Product Overview

Square & Rectangular Shape with Undermount Power - Inset 5"

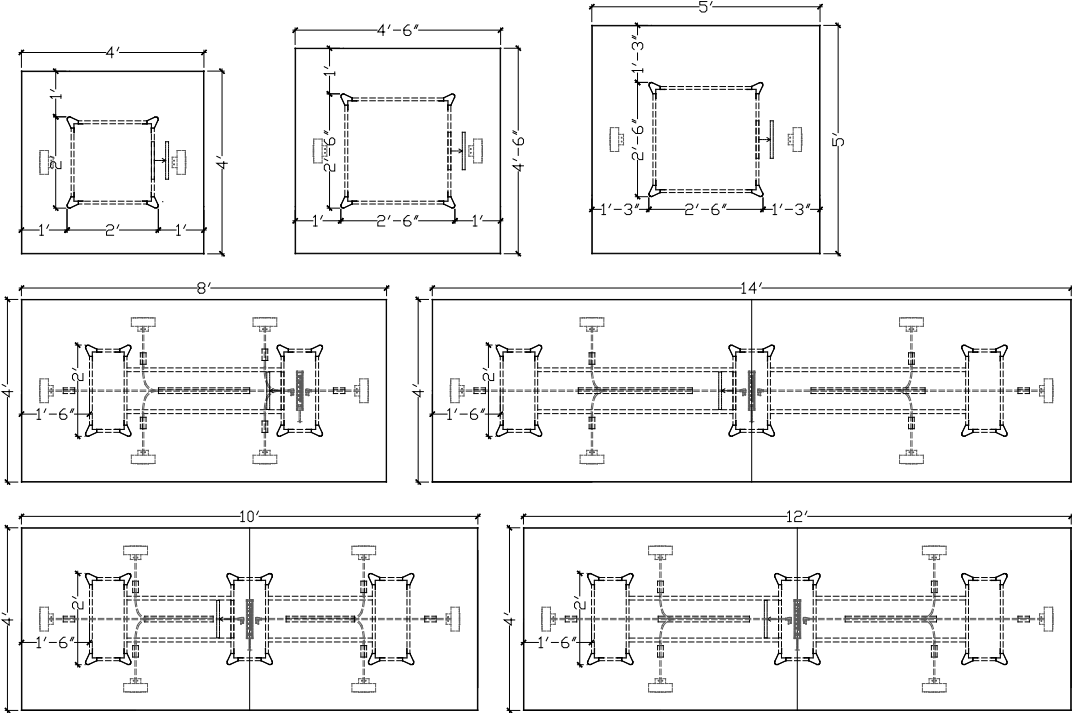

Arched Square & Boat Shape with Undermount Power - Inset 5"

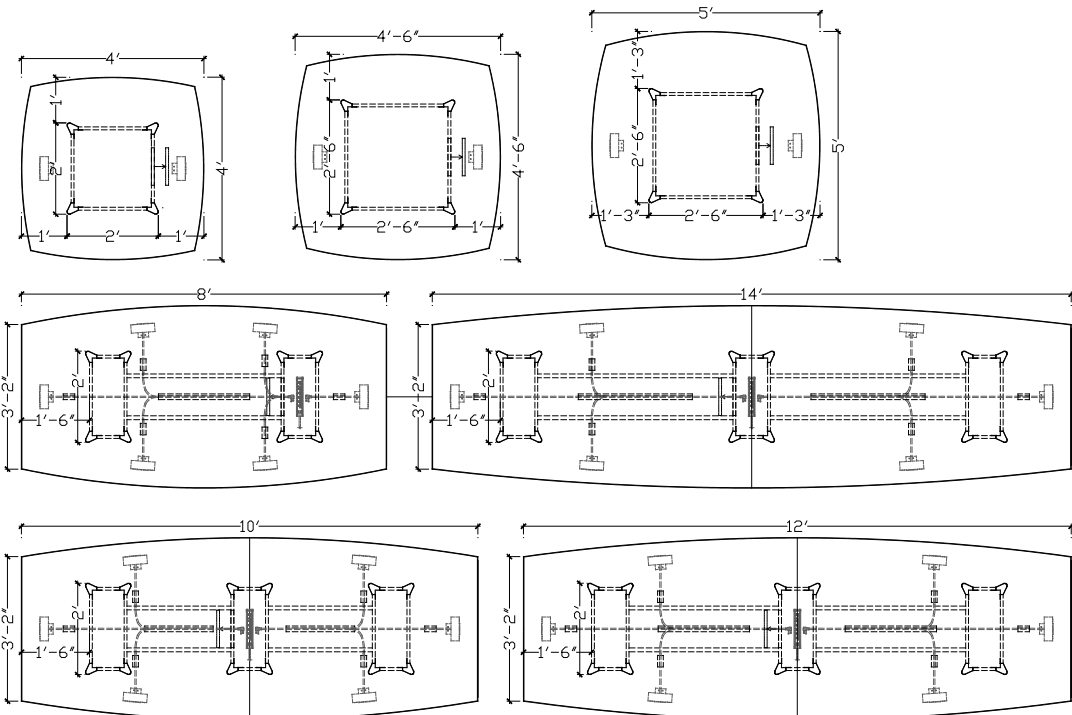

Conference Tables - Product Overview

Arc End Wedge Shape with 1.5" Reverse Taper Hardwood Edge & Undermount Power - Inset 5"

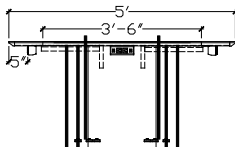
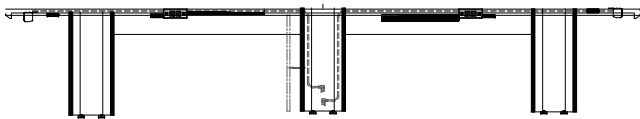
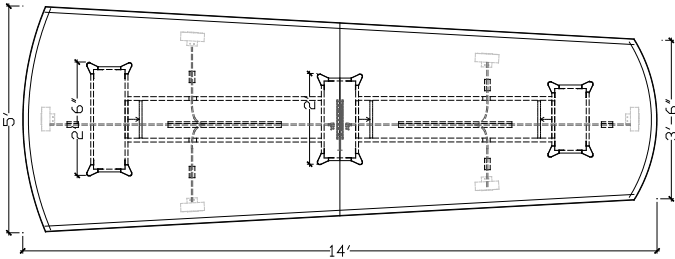
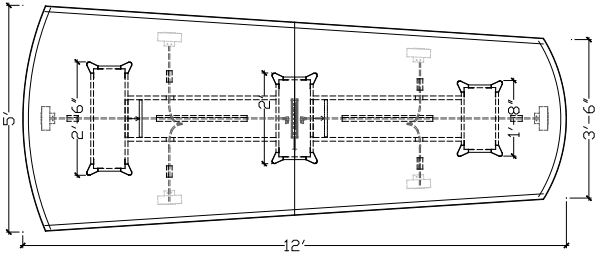
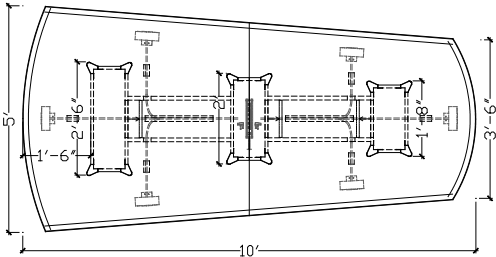
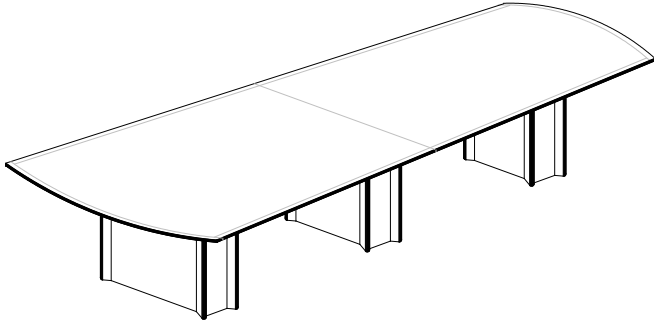

Square Conference Tables (Non-Powered)

Description	Product Code	3 MM PVC Edge		Dimensions			Cubic	
		ML Price	HPL Price	W	D	H	Weight	Feet

48" x 48" Square

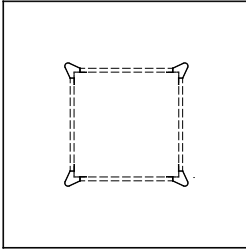

SQ 48 A24	1545	1730	48	48	29	166	50
-----------	------	------	----	----	----	-----	----

Includes:

- 48" x 48" Square Top, (1) Section
- (1) 24"w x 24"d Architectural Base with Silver Metal Corner Accents

54" x 54" Square

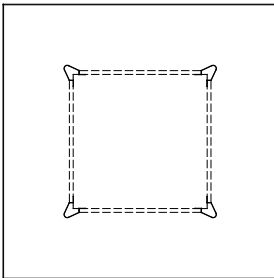

SQ 54 A30	1915	2120	54	54	29	215	64
-----------	------	------	----	----	----	-----	----

Includes:

- 54" x 54" Square Top, (1) Section
- (1) 30"w x 30"d Architectural Base with Silver Metal Corner Accents

60" x 60" Square

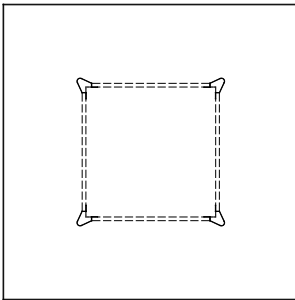

SQ 60 A30	2025	2260	60	60	29	233	78
-----------	------	------	----	----	----	-----	----

Includes:

- 60" x 60" Square Top, (1) Section
- (1) 30"w x 30"d Architectural Base with Silver Metal Corner Accents

Square with 1.5" Reverse Taper Hard Wood Edge

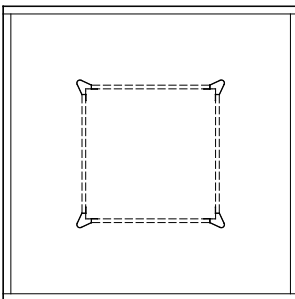
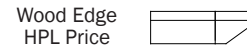

SQ 48 A24 W	3265	48	48	29	166	50
SQ 54 A30 W	3785	54	54	29	215	64
SQ 60 A30 W	4000	60	60	29	233	78

Arched Conference Tables (Non-Powered)

Description	Product Code	3 MM PVC Edge		Dimensions			Cubic	
		ML Price	HPL Price	W	D	H	Weight	Feet

48" x 48" Arched Square

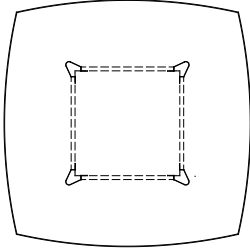

ASQ 48 A24	1655	1850	48	48	29	161	50
------------	------	------	----	----	----	-----	----

- Includes:
- 48" x 48" Arched Square Top, (1) Section
 - (1) 24" w x 24" d Architectural Base with Silver Metal Corner Accents

54" x 54" Arched Square

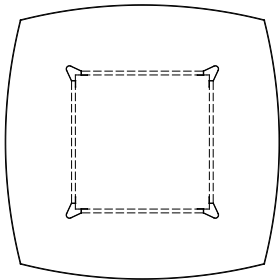

ASQ 54 A30	2040	2265	54	54	29	209	64
------------	------	------	----	----	----	-----	----

- Includes:
- 54" x 54" Arched Square Top, (1) Section
 - (1) 30" w x 30" d Architectural Base with Silver Metal Corner Accents

60" x 60" Arched Square

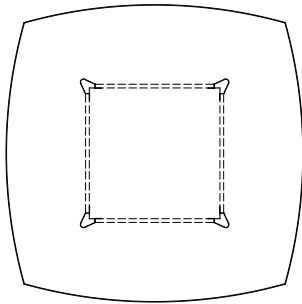

ASQ 60 A30	2185	2440	60	60	29	226	78
------------	------	------	----	----	----	-----	----

- Includes:
- 60" x 60" Arched Square Top, (1) Section
 - (1) 30" w x 30" d Architectural Base with Silver Metal Corner Accents

Arched Square with 1.5" Reverse Taper Hard Wood Edge

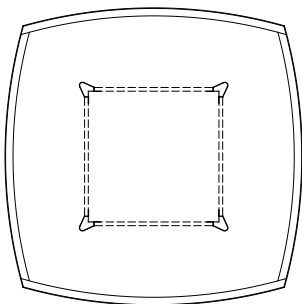
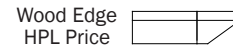

ASQ 48 A24 W	3440	48	48	29	161	50
ASQ 54 A30 W	3930	54	54	29	209	64
ASQ 60 A30 W	4145	60	60	29	226	78

Square Conference Tables (Powered - Desk Top)

Description	Product Code	3 MM PVC Edge		Dimensions			Cubic	
		ML Price	HPL Price	W	D	H	Weight	Feet

48" x 48" Square with Desk Top Power

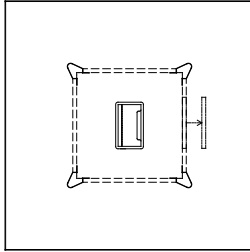

SQ 48 A24 P	2185	2370	48	48	29	179	50
-------------	------	------	----	----	----	-----	----

- Includes:
- 48" x 48" Square Top, (1) Section
 - (1) 24" w x 24" d Architectural Base with Silver Metal Corner Accents
 - (1) 10" x 28" Access Panel, Code: AP 1028
 - (1) Power Centre, (2) power, 72" Cord, Silver, Code: INT SP 012-72
 - Convenience Receptacle on underside
 - For Data Options reference Telecom Plates, page 24

54" x 54" Square with Desk Top Power

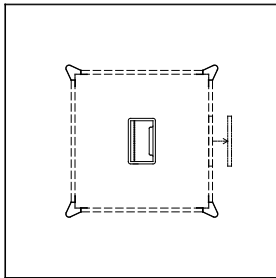

SQ 54 A30 P	2555	2760	54	54	29	228	64
-------------	------	------	----	----	----	-----	----

- Includes:
- 54" x 54" Square Top, (1) Section
 - (1) 30" w x 30" d Architectural Base with Silver Metal Corner Accents
 - (1) 10" x 28" Access Panel, Code: AP 1028
 - (1) Power Centre, (2) power, 72" Cord, Silver, Code: INT SP 012-72
 - Convenience Receptacle on underside
 - For Data Options reference Telecom Plates, page 24

60" x 60" Square with Desk Top Power

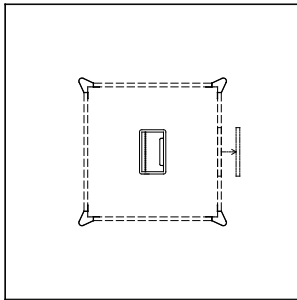

SQ 60 A30 P	2665	2900	60	60	29	246	78
-------------	------	------	----	----	----	-----	----

- Includes:
- 60" x 60" Square Top, (1) Section
 - (1) 30" w x 30" d Architectural Base with Silver Metal Corner Accents
 - (1) 10" x 28" Access Panel, Code: AP 1028
 - (1) Power Centre, (2) power, 72" Cord, Silver, Code: INT SP 012-72
 - Convenience Receptacle on underside
 - For Data Options reference Telecom Plates, page 24

Square with 1.5" Reverse Taper Hard Wood Edge & Desk Top Power

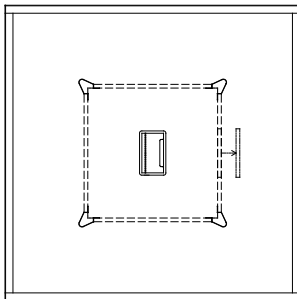

SQ 48 A24 W P	3905	48	48	29	179	50
SQ 54 A30 W P	4425	54	54	29	228	64
SQ 60 A30 W P	4640	60	60	29	246	78

Arched Conference Tables (Powered - Desk Top)

Description	Product Code	3 MM PVC Edge		Dimensions			Cubic	
		ML Price	HPL Price	W	D	H	Weight	Feet

48" x 48" Arched with Desk Top Power

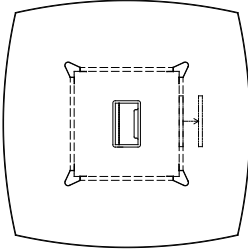

ASQ 48 A24 P	2295	2490	48	48	29	161	50
--------------	------	------	----	----	----	-----	----

Includes:

- 48" x 48" Arched Square Top, (1) Section
- (1) 24" w x 24" d Architectural Base with Silver Metal Corner Accents
- (1) 10" x 28" Access Panel, Code: AP 1028
- (1) Power Centre, (2) power, 72" Cord, Silver, Code: INT SP 012-72
- Convenience Receptacle on underside
- For Data Options reference Telecom Plates, page 24

54" x 54" Arched with Desk Top Power

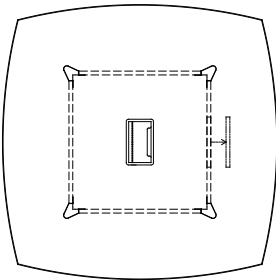

ASQ 54 A30 P	2680	2905	54	54	29	222	64
--------------	------	------	----	----	----	-----	----

Includes:

- 54" x 54" Arched Square Top, (1) Section
- (1) 30" w x 30" d Architectural Base with Silver Metal Corner Accents
- (1) 10" x 28" Access Panel, Code: AP 1028
- (1) Power Centre, (2) power, 72" Cord, Silver, Code: INT SP 012-72
- Convenience Receptacle on underside
- For Data Options reference Telecom Plates, page 24

60" x 60" Arched with Desk Top Power

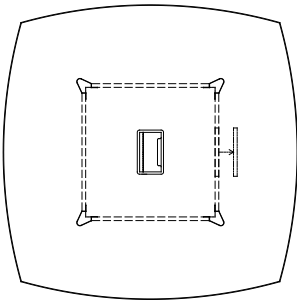

ASQ 60 A30 P	2825	3080	60	60	29	239	78
--------------	------	------	----	----	----	-----	----

Includes:

- 60" x 60" Arched Square Top, (1) Section
- (1) 30" w x 30" d Architectural Base with Silver Metal Corner Accents
- (1) 10" x 28" Access Panel, Code: AP 1028
- (1) Power Centre, (2) power, 72" Cord, Silver, Code: INT SP 012-72
- Convenience Receptacle on underside
- For Data Options reference Telecom Plates, page 24

Arched with 1.5" Reverse Taper Hard Wood Edge & Desk Top Power

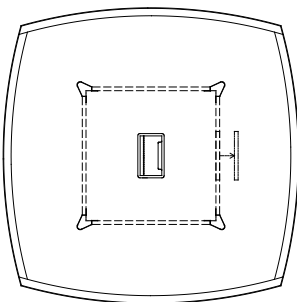

ASQ 48 A24 W P		4080	48	48	29	161	50
ASQ 54 A30 W P		4570	54	54	29	222	64
ASQ 60 A30 W P		4785	60	60	29	239	78

Square Conference Tables (Powered - Undermount)

Description	Product Code	3 MM PVC Edge		Dimensions			Cubic Feet
		ML Price	HPL Price	W	D	H	

48" x 48" Square with Undermount Power

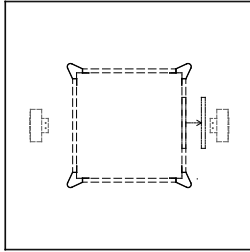

SQ 48 A24 PU2	2625	2810	48	48	29	179	50
---------------	------	------	----	----	----	-----	----

Includes:

- 48" x 48" Square Top, (1) Section
- (1) 24" w x 24" d Architectural Base with Silver Metal Corner Accents
- (1) 10" x 28" Access Panel, Code: AP 1028
- (2) Power Centres, (4) power, 108" Cord, Black, Code: SECL 22 BL-108
- (4) RJ 45 cat 6 data connectors
- For Additional Power & Data Options reference pages 23 & 24

54" x 54" Square with Undermount Power

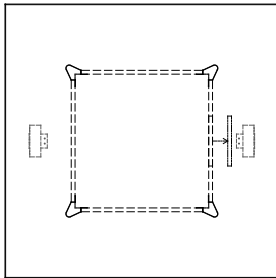

SQ 54 A30 PU2	2995	3200	54	54	29	228	64
---------------	------	------	----	----	----	-----	----

Includes:

- 60" x 60" Square Top, (1) Section
- (1) 30" w x 30" d Architectural Base with Silver Metal Corner Accents
- (1) 10" x 28" Access Panel, Code: AP 1028
- (2) Power Centres, (4) power, 108" Cord, Black, Code: SECL 22 BL-108
- (4) RJ 45 cat 6 data connectors
- For Additional Power & Data Options reference pages 23 & 24

60" x 60" Square with Undermount Power

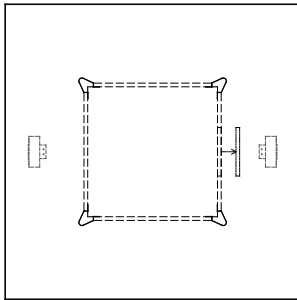

SQ 60 A30 PU2	3105	3340	60	60	29	246	78
---------------	------	------	----	----	----	-----	----

Includes:

- 60" x 60" Square Top, (1) Section
- (1) 30" w x 30" d Architectural Base with Silver Metal Corner Accents
- (1) 10" x 28" Access Panel, Code: AP 1028
- (2) Power Centres, (4) power, 108" Cord, Black, Code: SECL 22 BL-108
- (4) RJ 45 cat 6 data connectors
- For Additional Power & Data Options reference pages 23 & 24

Square with 1.5" Reverse Taper Hard Wood Edge & Undermount Power

Wood Edge
HPL Price 

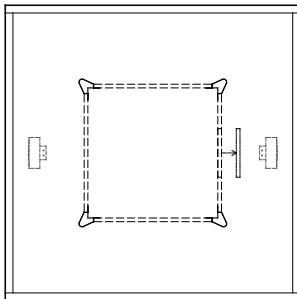

SQ 48 A24 W PU2		4345	48	48	29	179	50
SQ 54 A30 W PU2		4865	54	54	29	228	64
SQ 60 A30 W PU2		5080	60	60	29	246	78

Arched Conference Tables (Powered - Undermount)

Description	Product Code	3 MM PVC Edge		Dimensions			Cubic	
		ML Price	HPL Price	W	D	H	Weight	Feet

48" x 48" Arched with Undermount Power

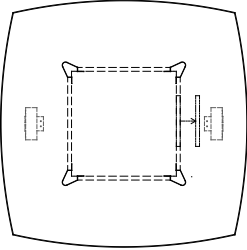

ASQ 48 A24 PU2	2735	2930	48	48	29	174	50
----------------	------	------	----	----	----	-----	----

Includes:

- 48" x 48" Arched Square Top, (1) Section
- (1) 24" w x 24" d Architectural Base with Silver Metal Corner Accents
- (1) 10" x 28" Access Panel, Code: AP 1028
- (2) Power Centres, (4) power, 108" Cord, Black, Code: SECL 22 BL-108
- (4) RJ 45 cat 6 data connectors
- For Additional Power & Data Options reference pages 23 & 24

54" x 54" Arched with Undermount Power

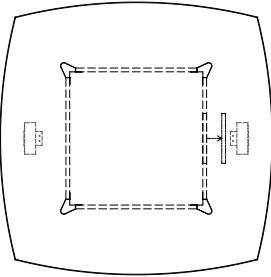

ASQ 54 A30 PU2	3120	3345	54	54	29	222	64
----------------	------	------	----	----	----	-----	----

Includes:

- 54" x 54" Arched Square Top, (1) Section
- (1) 30" w x 30" d Architectural Base with Silver Metal Corner Accents
- (1) 10" x 28" Access Panel, Code: AP 1028
- (2) Power Centres, (4) power, 108" Cord, Black, Code: SECL 22 BL-108
- (4) RJ 45 cat 6 data connectors
- For Additional Power & Data Options reference pages 23 & 24

60" x 60" Arched with Undermount Power

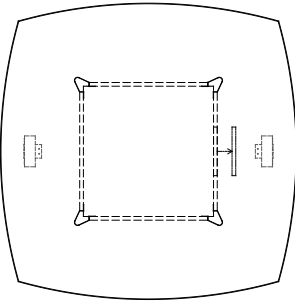

ASQ 60 A30 PU2	3265	3520	60	60	29	239	78
----------------	------	------	----	----	----	-----	----

Includes:

- 60" x 60" Arched Square Top, (1) Section
- (1) 30" w x 30" d Architectural Base with Silver Metal Corner Accents
- (1) 10" x 28" Access Panel, Code: AP 1028
- (2) Power Centres, (4) power, 108" Cord, Black, Code: SECL 22 BL-108
- (4) RJ 45 cat 6 data connectors
- For Additional Power & Data Options reference pages 23 & 24

Arched with 1.5" Reverse Taper Hard Wood Edge & Undermount Power

Wood Edge
HPL Price 

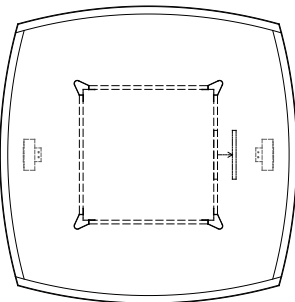

ASQ 48 A24 W PU2		4520	48	48	29	174	50
ASQ 54 A30 W PU2		5010	54	54	29	222	64
ASQ 60 A30 W PU2		5225	60	60	29	239	78

Rectangular Conference Tables (Non-Powered)

Description	Product Code	3 MM PVC Edge		Dimensions			Cubic Feet
		ML Price	HPL Price	W	D	H	

96" x 48" Rectangular

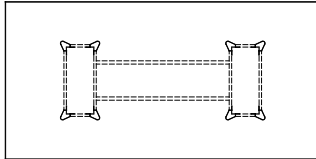

REC 9848 A24	2805	3190	96	48	29	271	100
--------------	------	------	----	----	----	-----	-----

Includes:

- 96" x 48" Rectangular Top, (1) Section
- (2) 12" w x 24" d Architectural Bases with Silver Metal Corner Accents
- (1) Set of 40.5" x 6" Linking Rails

120" x 48" Rectangular

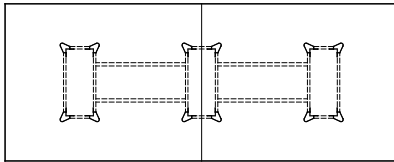

REC 12048 A24	4015	4445	120	48	29	366	65
---------------	------	------	-----	----	----	-----	----

Includes:

- 120" x 48" Rectangular Top, (2) Sections
- (3) 12" w x 24" d Architectural Bases with Silver Metal Corner Accents
- (2) Sets of 27.5" x 6" Linking Rails

144" & 168" x 48" Rectangular

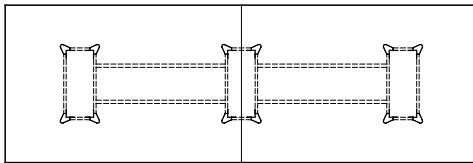

REC 14448 A24	4225	4740	144	48	29	405	78
---------------	------	------	-----	----	----	-----	----

Includes:

- 144" x 48" Rectangular Top, (2) Sections
- (3) 12" w x 24" d Architectural Bases with Silver Metal Corner Accents
- (2) Sets of 39.5" x 6" Linking Rails

REC 16848 A24	4670	5425	168	48	29	444	90
---------------	------	------	-----	----	----	-----	----

Includes:

- 168" x 48" Rectangular Top, (2) Sections
- (3) 12" w x 24" d Architectural Bases with Silver Metal Corner Accents
- (2) Sets of 51.5" x 6" Linking Rails

Rectangular with 1.5" Reverse Taper Hard Wood Edge

Wood Edge
HPL Price

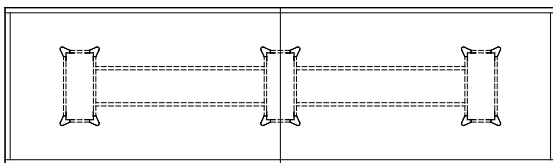
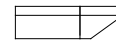

REC 9648 A24 W	4560	96	48	29	271	100
----------------	------	----	----	----	-----	-----

REC 12048 A24 W	6295	120	48	29	366	65
-----------------	------	-----	----	----	-----	----

REC 14448 A24 W	6640	144	54	29	405	78
-----------------	------	-----	----	----	-----	----

REC 16848 A24 W	7350	168	60	29	444	90
-----------------	------	-----	----	----	-----	----

Boat Shape Conference Tables (Non-Powered)

Description	Product Code	3 MM PVC Edge		Dimensions			Cubic Feet
		ML Price	HPL Price	W	D	H	

96" x 48/38" Boat Shape

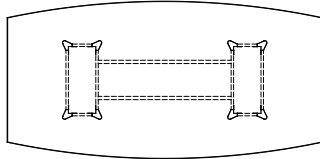

BT 964838 A24	2915	3315	96	48	29	261	100
---------------	------	------	----	----	----	-----	-----

Includes:

- 96" x 48/38" Boat Shape Top, (1) Section
- (2) 12" w x 24" d Architectural Bases with Silver Metal Corner Accents
- (1) Set of 40.5" x 6" Linking Rails

120" x 48/38" Boat Shape

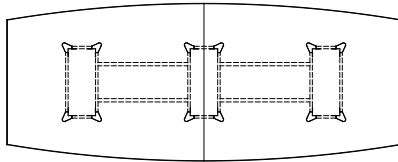

BT 1204838 A24	4155	4605	120	48	29	354	65
----------------	------	------	-----	----	----	-----	----

Includes:

- 120" x 48/38" Boat Shape Top, (2) Sections
- (3) 12" w x 24" d Architectural Bases with Silver Metal Corner Accents
- (2) Sets of 27.5" x 6" Linking Rails

144" & 168" x 48/38" Boat Shape

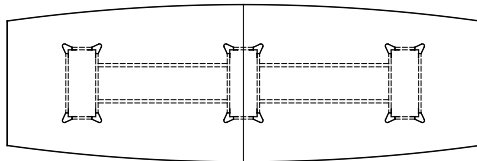

BT 1444838 A24	4390	4930	144	48	29	391	78
----------------	------	------	-----	----	----	-----	----

Includes:

- 144" x 48/38" Boat Shape Top, (2) Sections
- (3) 12" w x 24" d Architectural Bases with Silver Metal Corner Accents
- (2) Sets of 39.5" x 6" Linking Rails

BT 1684838 A24	4885	5670	168	48	29	428	90
----------------	------	------	-----	----	----	-----	----

Includes:

- 168" x 48/38" Boat Shape Top, (2) Sections
- (3) 12" w x 24" d Architectural Bases with Silver Metal Corner Accents
- (2) Sets of 51.5" x 6" Linking Rails

Boat Shape with 1.5" Reverse Taper Hard Wood Edge

Wood Edge
HPL Price

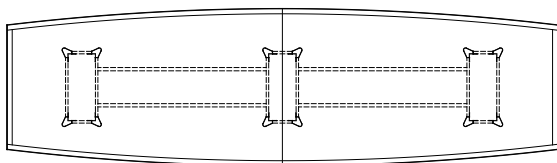

BT 984838 A24 W	4675	96	48	29	261	100
-----------------	------	----	----	----	-----	-----

BT 1204838 A24 W	6440	120	48	29	354	65
------------------	------	-----	----	----	-----	----

BT 1444838 A24 W	6815	144	48	29	391	78
------------------	------	-----	----	----	-----	----

BT 1684838 A24 W	7580	168	60	29	428	90
------------------	------	-----	----	----	-----	----

Rectangular Conference Tables (Powered - Desk Top)

Description	Product Code	3 MM PVC Edge		Dimensions			Cubic Feet
		ML Price	HPL Price	W	D	H	

96" x 48" Rectangular with Desk Top Power

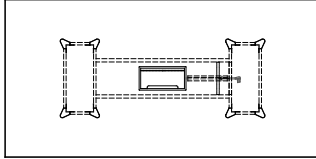

REC 9848 A24 P	4060	4445	96	48	29	285	100
----------------	------	------	----	----	----	-----	-----

- Includes:
- 96" x 48" Rectangular Top, (1) Section
 - (2) 12" w x 24" d Architectural Bases with Silver Metal Corner Accents
 - (1) 10" x 28" Access Panel, Code: AP 1028
 - (1) Set of 40.5" x 6" Linking Rails
 - (1) 12" Wire Manager
 - (1) Power Centre, (4) power, 72" Cord, Silver, Code: INT TTDC4-72
 - Convenience Receptacle on underside, 15 Amp circuit breaker
 - For Data Options reference Telecom Plates, page 24

120" x 48" Rectangular with Desk Top Power

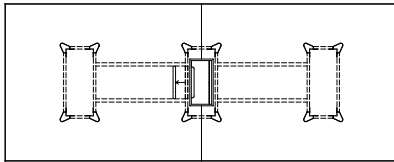

REC 12048 A24 P	5245	5675	120	48	29	380	65
-----------------	------	------	-----	----	----	-----	----

- Includes:
- 120" x 48" Rectangular Top, (2) Sections
 - (3) 12" w x 24" d Architectural Bases with Silver Metal Corner Accents
 - (1) 10" x 28" Access Panel, Code: AP 1028
 - (2) Sets of 27.5" x 6" Linking Rails
 - (1) Power Centre, (4) power, 72" Cord, Silver, Code: INT TTDC4-72
 - Convenience Receptacle on underside, 15 Amp circuit breaker
 - For Data Options reference Telecom Plates, page 24

144" & 168" x 48" Rectangular with Desk Top Power

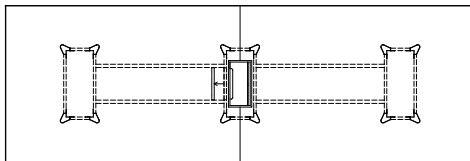

REC 14448 A24 P	5455	5970	144	48	29	419	78
-----------------	------	------	-----	----	----	-----	----

- Includes:
- 144" x 48" Rectangular Top, (2) Sections
 - (3) 12" w x 24" d Architectural Bases with Silver Metal Corner Accents
 - (1) 10" x 28" Access Panel, Code: AP 1028
 - (2) Sets of 39.5" x 6" Linking Rails
 - (1) Power Centre, (4) power, 72" Cord, Silver, Code: INT TTDC4-72
 - Convenience Receptacle on underside, 15 Amp circuit breaker
 - For Data Options reference Telecom Plates, page 24

REC 16848 A24 P	5900	6655	168	48	29	458	90
-----------------	------	------	-----	----	----	-----	----

- Includes:
- 168" x 48" Rectangular Top, (2) Sections
 - (3) 12" w x 24" d Architectural Bases with Silver Metal Corner Accents
 - (1) 10" x 28" Access Panel, Code: AP 1028
 - (2) Sets of 51.5" x 6" Linking Rails
 - (1) Power Centre, (4) power, 72" Cord, Silver, Code: INT TTDC4-72
 - Convenience Receptacle on underside, 15 Amp circuit breaker
 - For Data Options reference Telecom Plates, page 24

Rectangular with 1.5" Reverse Taper Hard Wood Edge & Desk Top Power

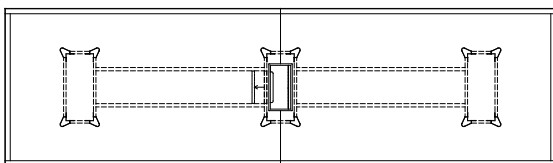
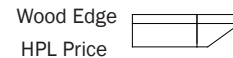

REC 9848 A24 W P		5815	48	48	29	285	100
REC 12048 A24 W P		7525	48	48	29	380	65
REC 14448 A24 W P		7870	54	54	29	419	78
REC 16848 A24 W P		8580	60	60	29	458	90

Boat Shape Conference Tables (Powered - Desk Top)

Description	Product Code	3 MM PVC Edge		Dimensions			Cubic Feet
		ML Price	HPL Price	W	D	H	

96" x 48/38" Boat Shape with Desk Top Power

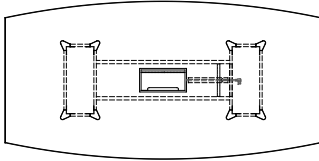

BT 9648 A24 P	4170	4570	96	48	29	275	100
---------------	------	------	----	----	----	-----	-----

- Includes:
- 96" x 48/38" Boat Shape Top, (1) Section
 - (2) 12" w x 24" d Architectural Bases with Silver Metal Corner Accents
 - (1) 10" x 28" Access Panel, Code: AP 1028
 - (1) Set of 40.5" x 6" Linking Rails
 - (1) 12" Wire Manager
 - (1) Power Centre, (4) power, 72" Cord, Silver, Code: INT TTDC4-72
 - Convenience Receptacle on underside, 15 Amp circuit breaker
 - For Data Options reference Telecom Plates, page 24

120" x 48/38" Boat Shape with Desk Top Power

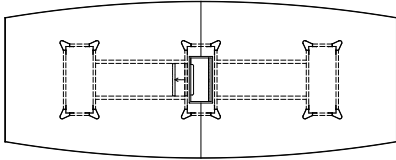

BT 12048 A24 P	5385	5835	120	48	29	368	65
----------------	------	------	-----	----	----	-----	----

- Includes:
- 120" x 48/38" Boat Shape Top, (2) Sections
 - (3) 12" w x 24" d Architectural Bases with Silver Metal Corner Accents
 - (1) 10" x 28" Access Panel, Code: AP 1028
 - (2) Sets of 27.5" x 6" Linking Rails
 - (1) Power Centre, (4) power, 72" Cord, Silver, Code: INT TTDC4-72
 - Convenience Receptacle on underside, 15 Amp circuit breaker
 - For Data Options reference Telecom Plates, page 24

144" & 168" x 48/38" Boat Shape with Desk Top Power

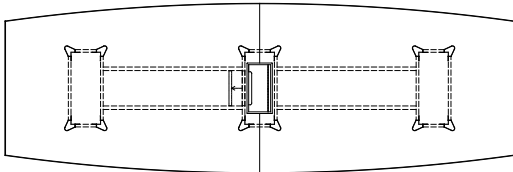

BT 1444838 A24 P	5620	6160	144	48	29	405	78
------------------	------	------	-----	----	----	-----	----

- Includes:
- 144" x 48/38" Boat Shape Top, (2) Sections
 - (3) 12" w x 24" d Architectural Bases with Silver Metal Corner Accents
 - (1) 10" x 28" Access Panel, Code: AP 1028
 - (2) Sets of 39.5" x 6" Linking Rails
 - (1) Power Centre, (4) power, 72" Cord, Silver, Code: INT TTDC4-72
 - Convenience Receptacle on underside, 15 Amp circuit breaker
 - For Data Options reference Telecom Plates, page 24

BT 1684838 A24 P	6115	6900	168	48	29	442	90
------------------	------	------	-----	----	----	-----	----

- Includes:
- 168" x 48/38" Boat Shape Top, (2) Sections
 - (3) 12" w x 24" d Architectural Bases with Silver Metal Corner Accents
 - (1) 10" x 28" Access Panel, Code: AP 1028
 - (2) Sets of 51.5" x 6" Linking Rails
 - (1) Power Centre, (4) power, 72" Cord, Silver, Code: INT TTDC4-72
 - Convenience Receptacle on underside, 15 Amp circuit breaker
 - For Data Options reference Telecom Plates, page 24

Boat Shape with 1.5" Reverse Taper Hard Wood Edge & Desk Top Power

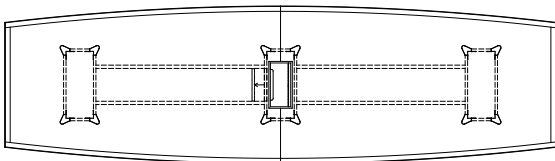
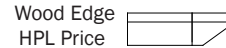

BT 964838 A24 W P	5930	96	48	29	275	100
-------------------	------	----	----	----	-----	-----

BT 1204838 A24 W P	7670	120	48	29	368	65
--------------------	------	-----	----	----	-----	----

BT 1444838 A24 W P	8045	144	48	29	405	78
--------------------	------	-----	----	----	-----	----

BT 1684838 A24 W P	8810	168	48	29	442	90
--------------------	------	-----	----	----	-----	----

Rectangular Conference Tables (Powered - Undermount)

Description	Product Code	3 MM PVC Edge		Dimensions		Cubic Weight Feet
		ML Price	HPL Price	W x D x H	Weight	

96" x 48" Rectangular with Undermount Power

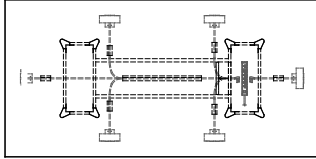

REC 9648 A24 PU6	5880	6265	96	48	29	296	100
------------------	------	------	----	----	----	-----	-----

Includes:

- 96" x 48" Rectangular Top, (1) Section
- (2) 12"w x 24"d Architectural Bases with Silver Metal Corner Accents
- (1) 10" x 28" Access Panel, Code: AP 1028
- (1) Set of 40.5" x 6" Linking Rails
- (6) 3" Wire Managers & (1) 24" Wire Managers
- (1) 6 Outlet Power Strip with Surge Protector, Code: PB 6-120
- (6) Power Centres, (12) power, 108" Cord, Black, Code: SECL 22 BL-108
- (12) RJ 45 cat 6 data connectors
- For Additional Power & Data Options reference pages 23 & 24

120" x 48" Rectangular with Undermount Power

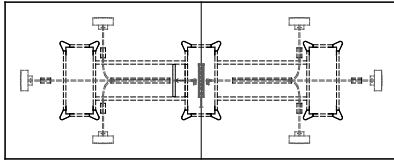

REC 12048 A24 PU6	7110	7540	120	48	29	393	65
-------------------	------	------	-----	----	----	-----	----

Includes:

- 120" x 48" Rectangular Top, (2) Sections
- (3) 12"w x 24"d Architectural Bases with Silver Metal Corner Accents
- (1) 10" x 28" Access Panel, Code: AP 1028
- (2) Sets of 27.5" x 6" Linking Rails
- (6) 3" Wire Managers & (2) 18" Wire Managers
- (1) 6 Outlet Power Strip with Surge Protector, Code: PB 6-120
- (6) Power Centres, (12) power, 108" Cord, Black, Code: SECL 22 BL-108
- (12) RJ 45 cat 6 data connectors
- For Additional Power & Data Options reference pages 23 & 24

144" & 168" x 48" Rectangular with Undermount Power

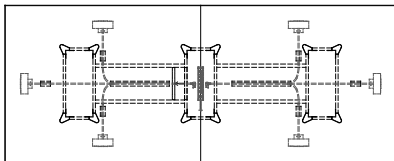

REC 14448 A24 PU6	7350	7865	144	48	29	433	78
-------------------	------	------	-----	----	----	-----	----

Includes:

- 144" x 48" Rectangular Top, (2) Sections
- (3) 12"w x 24"d Architectural Bases with Silver Metal Corner Accents
- (1) 10" x 28" Access Panel, Code: AP 1028
- (2) Sets of 39.5" x 6" Linking Rails
- (6) 3" Wire Managers & (2) 24" Wire Managers
- (1) 6 Outlet Power Strip with Surge Protector, Code: PB 6-120
- (6) Power Centres, (12) power, 108" Cord, Black, Code: SECL 22 BL-108
- (12) RJ 45 cat 6 data connectors
- For Additional Power & Data Options reference pages 23 & 24

REC 16848 A24 PU6	7815	8570	168	48	29	473	90
-------------------	------	------	-----	----	----	-----	----

Includes:

- 168" x 48" Rectangular Top, (2) Sections
- (3) 12"w x 24"d Architectural Bases with Silver Metal Corner Accents
- (1) 10" x 28" Access Panel, Code: AP 1028
- (2) Sets of 51.5" x 6" Linking Rails
- (6) 3" Wire Managers & (2) 30" Wire Managers
- (1) 6 Outlet Power Strip with Surge Protector, Code: PB 6-120
- (6) Power Centres, (12) power, 108" Cord, Black, Code: SECL 22 BL-108
- (12) RJ 45 cat 6 data connectors
- For Additional Power & Data Options reference pages 23 & 24

Rectangular with 1.5" Reverse Taper Hard Wood Edge & Undermount Power

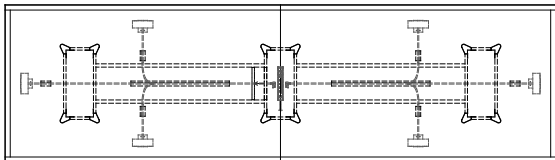

REC 9648 A24 W PU6		7635	96	48	29	296	100
REC 12048 A24 W PU6		9390	120	48	29	393	65
REC 14448 A24 W PU6		9765	144	48	29	433	78
REC 16848 A24 W PU6		10495	168	48	29	473	90

Boat Shape Conference Tables (Powered - Undermount)

Description	Product Code	3 MM PVC Edge		Dimensions W x D x H	Cubic Weight Feet
		ML Price	HPL Price		

96" x 48/38" Boat Shape with Undermount Power

BT 964838 A24 PU6	5990	6390	96	48	29	286	100
-------------------	------	------	----	----	----	-----	-----

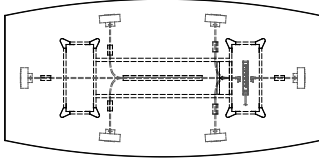

Includes:

- 96" x 48/38" Boat Shape Top, (1) Section
- (2) 12"w x 24"d Architectural Bases with Silver Metal Corner Accents
- (1) 10" x 28" Access Panel, Code: AP 1028
- (1) Set of 40.5" x 6" Linking Rails
- (6) 3" Wire Managers & (1) 24" Wire Managers
- (1) 6 Outlet Power Strip with Surge Protector, Code: PB 6-120
- (6) Power Centres, (12) power, 108" Cord, Black, Code: SECL 22 BL-108
- (12) RJ 45 cat 6 data connectors
- For Additional Power & Data Options reference pages 23 & 24

120" x 48/38" Boat Shape with Undermount Power

BT 1204838 A24 PU6	7250	7700	120	48	29	381	65
--------------------	------	------	-----	----	----	-----	----

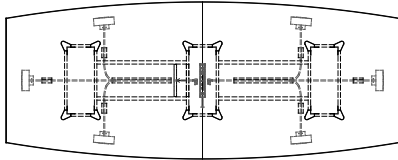

Includes:

- 120" x 48/38" Boat Shape Top, (2) Sections
- (3) 12"w x 24"d Architectural Bases with Silver Metal Corner Accents
- (1) 10" x 28" Access Panel, Code: AP 1028
- (2) Sets of 27.5" x 6" Linking Rails
- (6) 3" Wire Managers & (2) 18" Wire Managers
- (1) 6 Outlet Power Strip with Surge Protector, Code: PB 6-120
- (6) Power Centres, (12) power, 108" Cord, Black, Code: SECL 22 BL-108
- (12) RJ 45 cat 6 data connectors
- For Additional Power & Data Options reference pages 23 & 24

144" & 168" x 48/38" Boat Shape with Undermount Power

BT 1444838 A24 PU6	7515	8055	144	48	29	419	78
--------------------	------	------	-----	----	----	-----	----

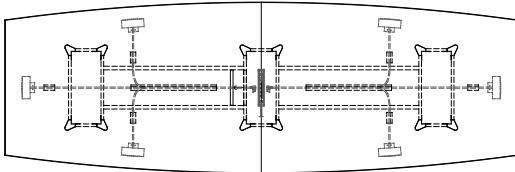

Includes:

- 144" x 48/38" Boat Shape Top, (2) Sections
- (3) 12"w x 24"d Architectural Bases with Silver Metal Corner Accents
- (1) 10" x 28" Access Panel, Code: AP 1028
- (2) Sets of 39.5" x 6" Linking Rails
- (6) 3" Wire Managers & (2) 24" Wire Managers
- (1) 6 Outlet Power Strip with Surge Protector, Code: PB 6-120
- (6) Power Centres, (12) power, 108" Cord, Black, Code: SECL 22 BL-108
- (12) RJ 45 cat 6 data connectors
- For Additional Power & Data Options reference pages 23 & 24

BT 1684838 A24 PU6	8030	8815	168	48	29	457	90
--------------------	------	------	-----	----	----	-----	----

Includes:

- 168" x 48/38" Boat Shape Top, (2) Sections
- (3) 12"w x 24"d Architectural Bases with Silver Metal Corner Accents
- (1) 10" x 28" Access Panel, Code: AP 1028
- (2) Sets of 51.5" x 6" Linking Rails
- (6) 3" Wire Managers & (2) 30" Wire Managers
- (1) 6 Outlet Power Strip with Surge Protector, Code: PB 6-120
- (6) Power Centres, (12) power, 108" Cord, Black, Code: SECL 22 BL-108
- (12) RJ 45 cat 6 data connectors
- For Additional Power & Data Options reference pages 23 & 24

Boat Shape with 1.5" Reverse Taper Hard Wood Edge & Undermount Power

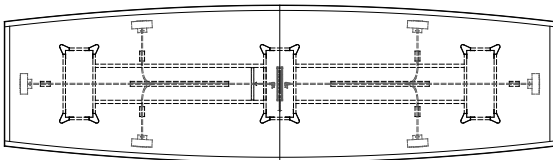
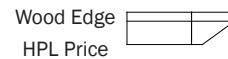

BT 964838 A24 W PU6		7750	96	48	29	286	100
---------------------	--	------	----	----	----	-----	-----

BT 1204838 A24 W PU6		9535	120	48	29	381	65
----------------------	--	------	-----	----	----	-----	----

BT 1444838 A24 W PU6		9940	144	48	29	419	78
----------------------	--	------	-----	----	----	-----	----

BT 1684838 A24 W PU6		10725	168	48	29	457	90
----------------------	--	-------	-----	----	----	-----	----

Arc End Wedge Conference Tables (Non-Powered)

Description	Product Code	3 MM PVC Edge		Dimensions		Cubic Feet
		ML Price	HPL Price	W	D x H	

120" x 60/42" Arc End Wedge

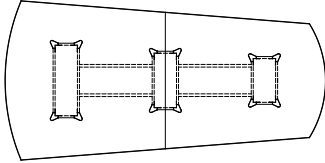

AEW 1206042 AB 4255 4710 120 60 29 369 81

Includes:

- 120" x 60" x 48" Arc End Wedge Top, (2) Sections
- (1) 12"w x 30"d Architectural Base with Silver Metal Corner Accents
- (1) 12"w x 24"d Architectural Base with Silver Metal Corner Accents
- (1) 12"w x 20"d Architectural Base with Silver Metal Corner Accents
- (2) Sets of 27.5" x 6" Linking Rails

144" x 60/42" Arc End Wedge

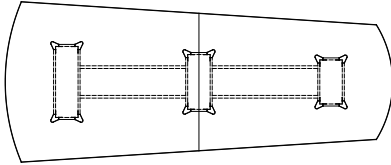

AEW 1446042 AB 4505 5050 144 60 29 408 96

Includes:

- 144" x 60" x 48" Arc End Wedge Top, (2) Sections
- (1) 12"w x 30"d Architectural Base with Silver Metal Corner Accents
- (1) 12"w x 24"d Architectural Base with Silver Metal Corner Accents
- (1) 12"w x 20"d Architectural Base with Silver Metal Corner Accents
- (2) Sets of 39.5" x 6" Linking Rails

168" x 60/42" Arc End Wedge

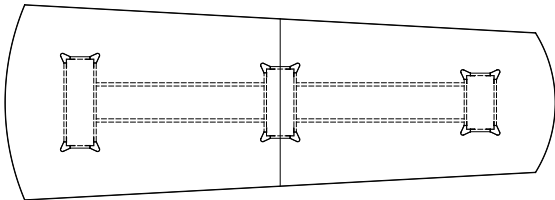

AEW 1686042 AB 5015 5810 168 60 29 447 112

Includes:

- 168" x 60" x 48" Arc End Wedge Top, (2) Sections
- (1) 12"w x 30"d Architectural Base with Silver Metal Corner Accents
- (1) 12"w x 24"d Architectural Base with Silver Metal Corner Accents
- (1) 12"w x 20"d Architectural Base with Silver Metal Corner Accents
- (2) Sets of 51.5" x 6" Linking Rails

Arc End Wedge with 1.5" Reverse Taper Hard Wood Edge

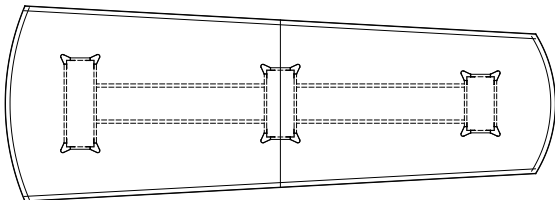
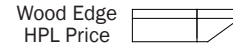

AEW 1206042 AB W 6495 120 60 29 369 81

AEW 1446042 AB W 6870 144 60 29 408 96

AEW 1686042 AB W 7635 168 60 29 447 112

Arc End Wedge Conference Tables (Powered - Undermount)

Description	Product Code	3 MM PVC Edge		Dimensions			Cubic Weight Feet
		ML Price	HPL Price	W	D	H	

120" x 60/42" Arc End Wedge with Undermount Power

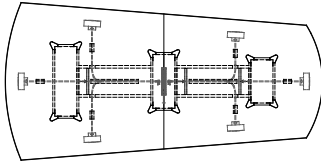

AEW 1206042 AB PU6 7350 7805 120 60 29 399 81

Includes:

- 120" x 60" x 48" Arc End Wedge Top, (2) Sections
- (1) 12"w x 30"d Architectural Base with Silver Metal Corner Accents
- (1) 12"w x 24"d Architectural Base with Silver Metal Corner Accents
- (1) 12"w x 20"d Architectural Base with Silver Metal Corner Accents
- (2) Sets of 27.5" x 6" Linking Rails
- (1) 10" x 28" Access Panel, Code: AP 1028
- (6) 3" Wire Managers & (2) 18" Wire Managers
- (1) 6 Outlet Power Strip with Surge Protector, Code: PB 6-120
- (6) Power Centres, (12) power, 108" Cord, Black, Code: SECL 22 BL-108
- (12) RJ 45 cat 6 data connectors
- For Additional Power & Data Options reference pages 23 & 24

144" x 60/42" Arc End Wedge with Undermount Power

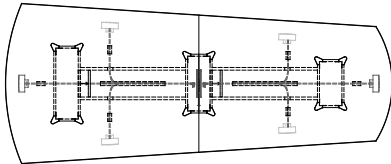

AEW 1446042 AB PU6 7630 8175 144 60 29 439 96

Includes:

- 144" x 60" x 48" Arc End Wedge Top, (2) Sections
- (1) 12"w x 30"d Architectural Base with Silver Metal Corner Accents
- (1) 12"w x 24"d Architectural Base with Silver Metal Corner Accents
- (1) 12"w x 20"d Architectural Base with Silver Metal Corner Accents
- (2) Sets of 39.5" x 6" Linking Rails
- (1) 10" x 28" Access Panel, Code: AP 1028
- (6) 3" Wire Managers & (2) 24" Wire Managers
- (1) 6 Outlet Power Strip with Surge Protector, Code: PB 6-120
- (6) Power Centres, (12) power, 108" Cord, Black, Code: SECL 22 BL-108
- (12) RJ 45 cat 6 data connectors
- For Additional Power & Data Options reference pages 23 & 24

168" x 60/42" Arc End Wedge with Undermount Power

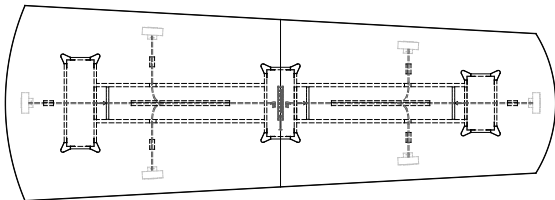

AEW 1686042 AB PU6 8160 8955 168 60 29 479 112

Includes:

- 168" x 60" x 48" Arc End Wedge Top, (2) Sections
- (1) 12"w x 30"d Architectural Base with Silver Metal Corner Accents
- (1) 12"w x 24"d Architectural Base with Silver Metal Corner Accents
- (1) 12"w x 20"d Architectural Base with Silver Metal Corner Accents
- (2) Sets of 51.5" x 6" Linking Rails
- (1) 10" x 28" Access Panel, Code: AP 1028
- (6) 3" Wire Managers & (2) 30" Wire Managers
- (1) 6 Outlet Power Strip with Surge Protector, Code: PB 6-120
- (6) Power Centres, (12) power, 108" Cord, Black, Code: SECL 22 BL-108
- (12) RJ 45 cat 6 data connectors
- For Additional Power & Data Options reference pages 23 & 24

Arc End Wedge with 1.5" Reverse Taper Hard Wood Edge & Undermount Power

Wood Edge
HPL Price 

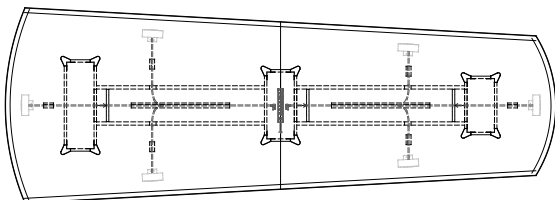







AEW 1206042 AB PU6 9590 120 60 29 399 81

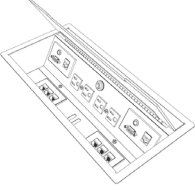

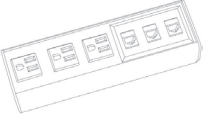

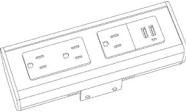

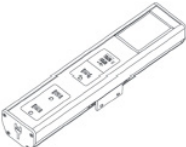
AEW 1446042 AB PU6 9995 144 60 29 439 96

AEW 1686042 AB PU6 10780 168 60 29 479 112

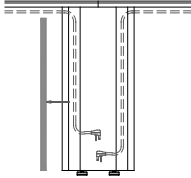
Power Solutions & Accessories

Description	Product Code	Power Centres	Dimensions W x D x H	Weight	Cubic Feet
Desk Top 2 Power 	INT SP 012-72	460	10 6.5 2.6	5	0.1
	Includes:				
	<ul style="list-style-type: none"> • (2) Power Receptacles, 15 Amp Circuit Breaker • (1) Convenience Receptacle on underside • (1) Cutout for Telecom Plate • 72" Cord with Moulded Plug • Silver Finish Standard • For Data Options reference Telecom Plates, page 24 				
Desk Top 4 Power 	INT TTDC4-72	1050	14.5 6.5 3	7	0.2
	Includes:				
	<ul style="list-style-type: none"> • (4) Power Receptacles, 15 Amp Circuit Breaker • (1) Convenience Receptacle on underside • (4) Cutouts for Telecom • 72" Cord with Moulded Plug Plates • Silver Finish Standard • For Data Options reference Telecom Plates, page 24 				
Undermount 2 Power & 2 Data 	SECL 22 BL-108	450	6.3 2.2 2.5	2.5	0.08
	Includes:				
	<ul style="list-style-type: none"> • (2) Power Receptacles • (2) RJ45's • 108" Cord with Moulded Plug, Black 				
Undermount 3 Power & 1 Telecom Plate Cutout 	SECL 3C BL-108	465	8.2 2.2 2.5	3	0.1
	Includes:				
	<ul style="list-style-type: none"> • (3) Power Receptacles • (1) Telecom Plate Cutout • 108" Cord with Moulded Plug, Black • For Data Options reference Telecom Plates, page 24 				
Undermount 1 Power & 2 USB 	SECL-1USB-B-108	505	3.5 2.2 2.5	2	0.06
	Includes:				
	<ul style="list-style-type: none"> • (1) Power Receptacle • (2) USB • 108" Cord with Moulded Plug, Black 				
Undermount 3 Power & 2 USB 	SECL-3USB-B-108	520	8.3 2.2 2.5	3	0.1
	Includes:				
	<ul style="list-style-type: none"> • (3) Power Receptacles • (2) USB • 108" Cord with Moulded Plug, Black 				
Undermount 1 Power, 2 USB & 1 Telecom Plate Cutout 	SECL-1U-D-B-108	505	8.3 2.2 2.5	3	0.1
	Includes:				
	<ul style="list-style-type: none"> • (1) Power Receptacle • (2) USB • (1) Telecom Plate Cutout • 108" Cord with Moulded Plug, Black • For Data Options reference Telecom Plates, page 24 				
Undermount 3 Power, 2 USB & 1 Telecom Plate Cutout 	SECL-3U-D-B-108	520	11.5 2.2 2.5	3.5	0.13
	Includes:				
	<ul style="list-style-type: none"> • (3) Power Receptacles • (2) USB • (1) Telecom Plate Cutout • 108" Cord with Moulded Plug, Black • For Data Options reference Telecom Plates, page 24 				

Power Solutions & Accessories

Description	Product Code	Power Accessories	Dimensions W x D x H	Weight	Cubic Feet
Power Strip 	PB 6-120	85	11 2.3 1.8	3	0.03
	Includes:				
	<ul style="list-style-type: none"> • (6) Outlets, 15 Amp Circuit Breaker • Surge Protection with Surge Indicator Light • On/Off Illuminated Switch • 120" Cord with Moulded Plug • Putty Finish Standard • Built-In Keyhole Slots for easy mounting 				
Access Panel 	AP 1028	180	10 0.8 27.5	5	0.15
	Includes:				
	<ul style="list-style-type: none"> • (4) Furniture Connectors • (1) 4" x 2" Cable Cutout • PVC Edge 				
J - Wire Managers 	JWR 6	15	6 1.1 2.3	0.5	0.01
	JWR 12	25	12 1.1 2.3	1	0.02
	JWR 18	35	18 1.1 2.3	1.5	0.03
	JWR 24	50	24 1.1 2.3	2	0.04
	JWR 30	60	30 1.1 2.3	2.5	0.05
Telecom Plate, Blank 	TP BL	15	3.2 0.3 1.9	0.07	0.01
	Includes:				
	<ul style="list-style-type: none"> • (1) Blank Telecom Plate 				
Telecom Plate with 1 Data Connector 	TP 1D	85	3.2 1.2 1.9	0.08	0.01
	Includes:				
	<ul style="list-style-type: none"> • (1) Telecom Plate with Cutout • (1) RJ 45, Cat 6 Connector with Icon Plates 				
Telecom Plate with 2 Data Connectors 	TP 2D	155	3.2 1.2 1.9	0.13	0.01
	Includes:				
	<ul style="list-style-type: none"> • (1) Telecom Plate with Cutout • (2) RJ 45, Cat 6 Connector with Icon Plates 				
Telecom Plate with 3 Data Connectors 	TP 3D	230	3.2 1.2 1.9	0.14	0.01
	Includes:				
	<ul style="list-style-type: none"> • (1) Telecom Plate with Cutouts • (3) RJ 45, Cat 6 Connector with Icon Plates 				
Telecom Plate with HDMI, Mini Stereo & HD VGA 	TP HD MS VGA	350	3.2 1.8 1.9	0.22	0.01
	Includes:				
	<ul style="list-style-type: none"> • (1) Telecom Plate with Cutouts • (1) HDMI Female/Female with 36" Patch Cord attached • (1) Mini Stereo Inline • (1) 15 Pin HD VGA Female/Female with 72" Patch Cord attached 				

